

**Chose language**

**Press the start button**

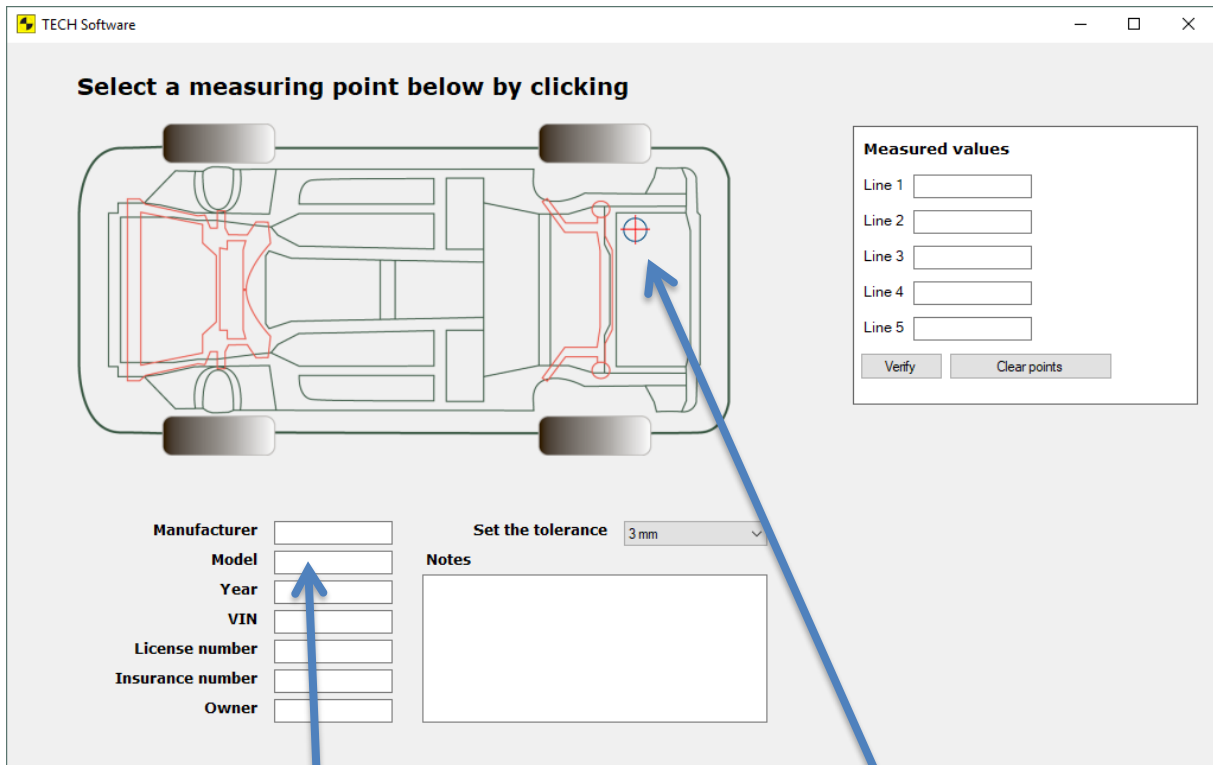

**Fill out the car details**

**Select by clicking where you want to start measuring from**

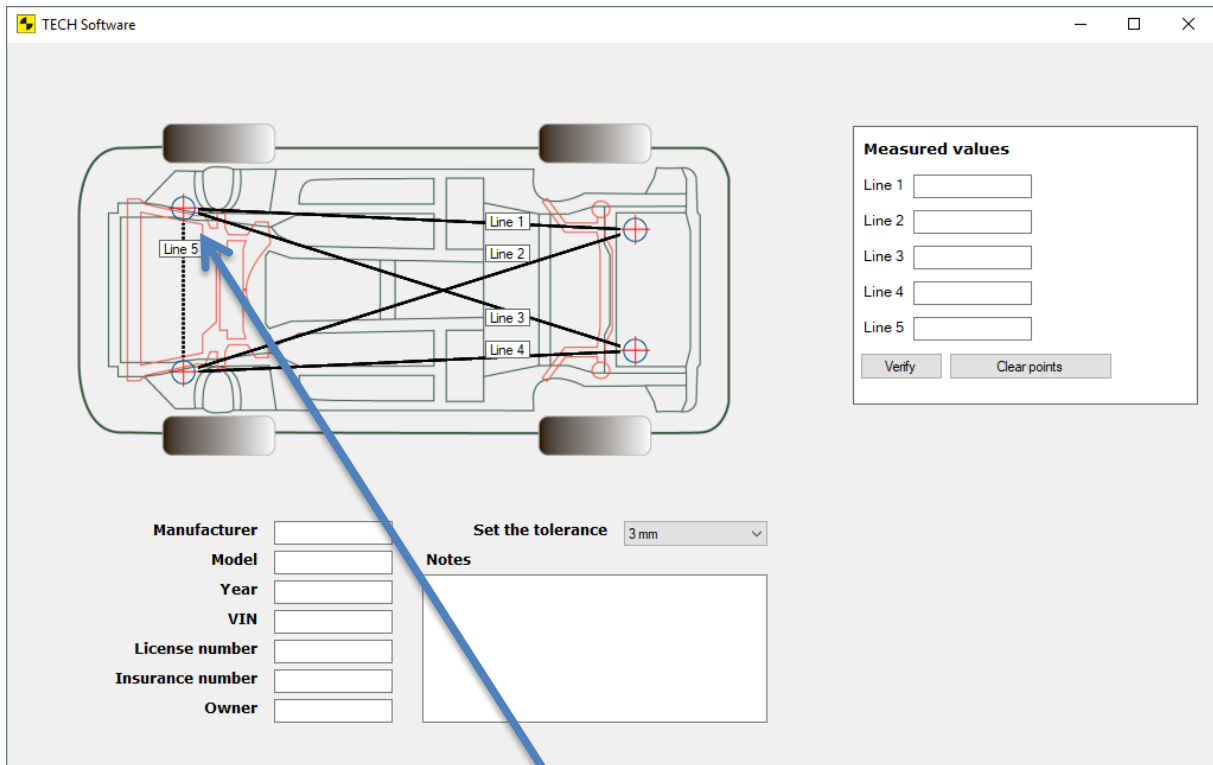

**Draw the arrow to the point you will be measuring to and click. 5 lines will be drawn to the chassis image.**

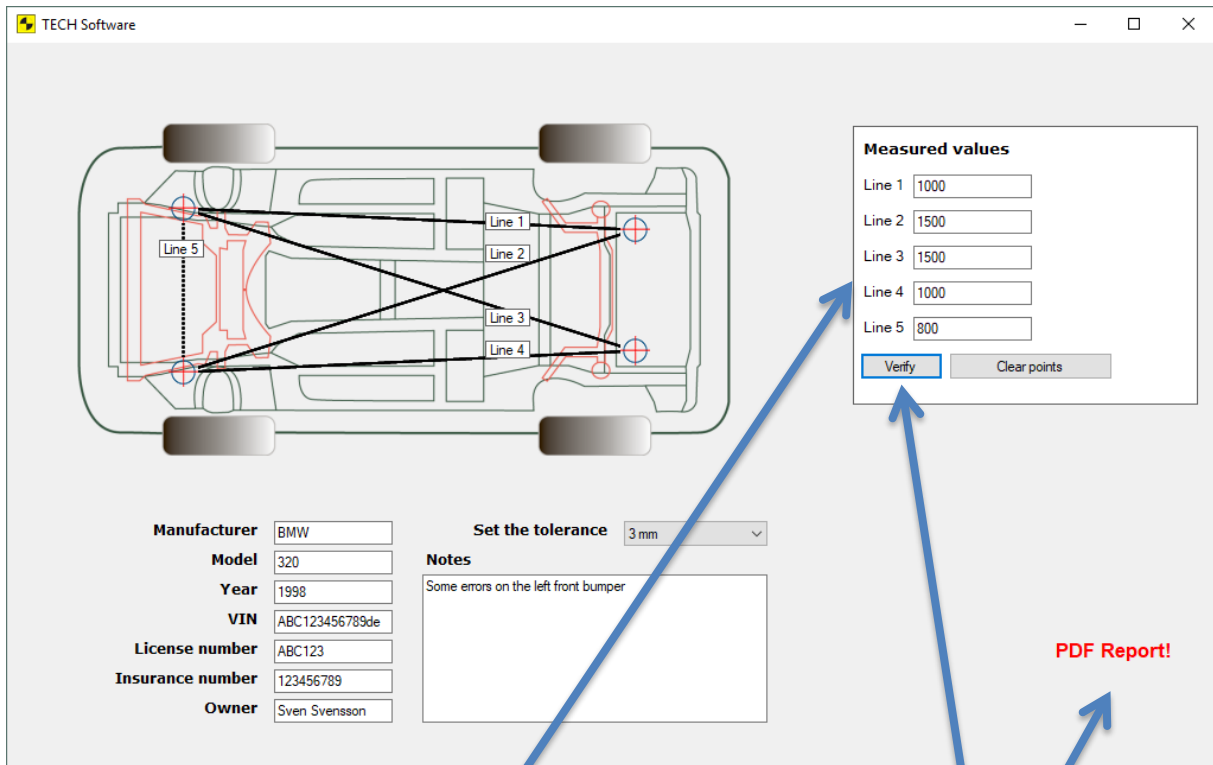

**Fill out the measuring value for each line on the chassis image.**

**Click on the verify button and then click on PDF Report**

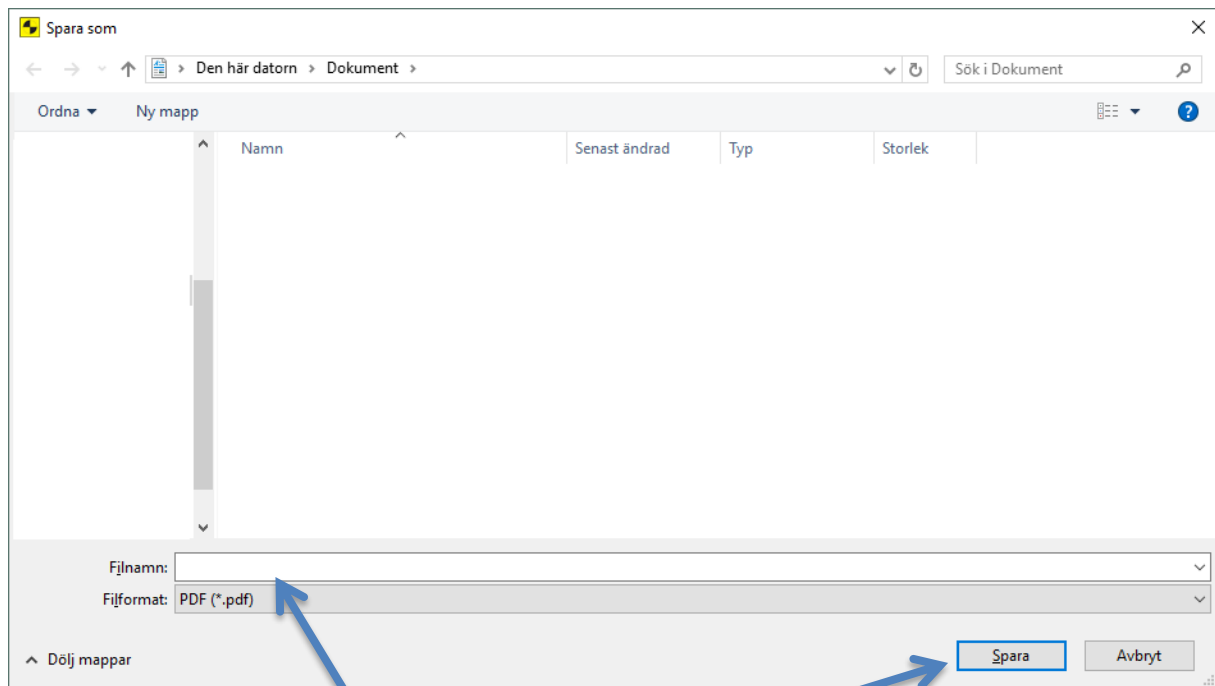

**Name the file.**

**Click on Save.**

report.pdf - Adobe Acrobat Pro

File Edit View Window Help

Create [Icons]

1 / 1 [Navigation] 71,1% [Zoom] Tools Comment Share

Report 2018-02-19

OK

	Measured values	
Line 1	1000	✓
Line 2	1500	✓
Line 3	1500	✓
Line 4	1000	✓
Line 5	800	✓

<b>Manufacturer</b>	BMW
<b>Model</b>	320
<b>Year</b>	1998
<b>VIN</b>	ABC123456789de
<b>License number</b>	ABC123
<b>Insurance number</b>	123456789
<b>Owner</b>	Sven Svensson
<b>Set the tolerance</b>	3 mm

Notes
Some errors on the left front bumper

Now you have a date-secure report with the measuring situation, and an **OK** confirmation if the car is ok.

TECH Software

Please fill in the specification values and verify

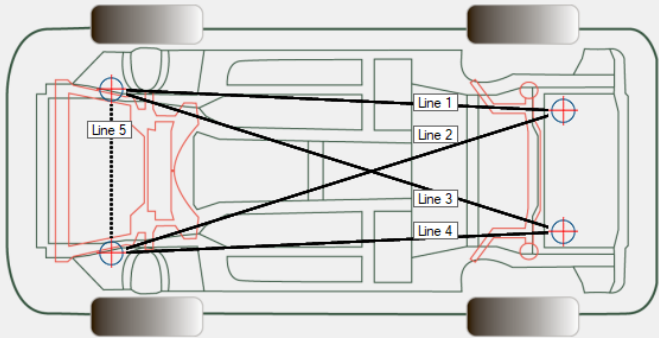

Measured values	Spec. values
Line 1 1400	<input type="text"/>
Line 2 1900	<input type="text"/>
Line 3 1890	<input type="text"/>
Line 4 1406	<input type="text"/>
Line 5 900	<input type="text"/>

Verify Clear points

Manufacturer BMW Set the tolerance 3 mm

Model 320

Year 1998

VIN ABC123456789de

License number ABC123

Insurance number 123456789

Owner Sven Svensson

Notes  
Some errors on the left front bumper

PDF Report!

If the fields are red after verification, there are 3 possibilities:

1. The car is damaged
2. The points are not symmetric
3. The tolerance is wrong

Fill in the car manufacture's values for these lines, or values from another supplier of data.

TECH Software

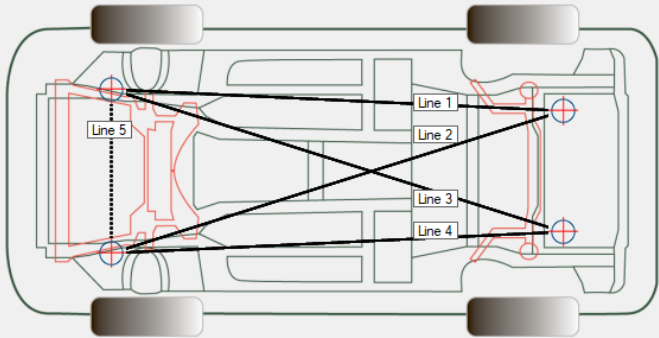

	Measured values	Spec. values
Line 1	1400	1400
Line 2	1900	1900
Line 3	1890	1900
Line 4	1406	1406
Line 5	900	900

Verify Clear points

**Manufacturer** BMW  
**Model** 320  
**Year** 1998  
**VIN** ABC123456789de  
**License number** ABC123  
**Insurance number** 123456789  
**Owner** Sven Svensson

**Set the tolerance** 3 mm

**Notes**  
Some errors on the left front bumper

**PDF Report!**

Example of a damage car



report.pdf - Adobe Acrobat Pro

File Edit View Window Help

Create

1 / 1 71,4%

Tools Comment Share

**Report**  
2018-02-19

	Measured values	Spec. values	
Line 1	1400	1400	✓
Line 2	1900	1900	✓
Line 3	1890	1900	! (red)
Line 4	1406	1406	✓
Line 5	900	900	✓

<b>Manufacturer</b>	BMW
<b>Model</b>	320
<b>Year</b>	1998
<b>VIN</b>	ABC123456789de
<b>License number</b>	ABC123
<b>Insurance number</b>	123456789
<b>Owner</b>	Sven Svensson
<b>Set the tolerance</b>	3 mm

Notes
Some errors on the left front bumper

Example of a report on a damaged car

TECH Software

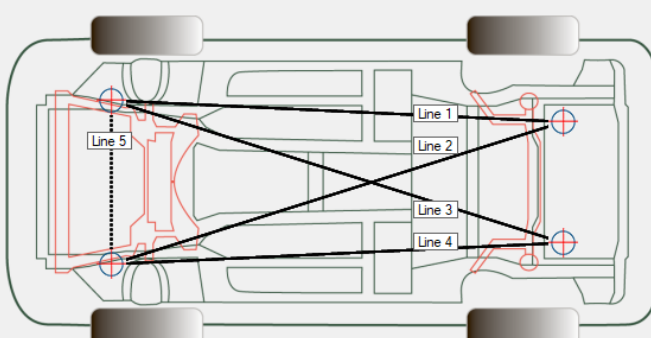

Measured values	Spec. values
Line 1	1400
Line 2	1900
Line 3	1890
Line 4	1406
Line 5	900

Verify Clear points

**Manufacturer** BMW  
**Model** 320  
**Year** 1998  
**VIN** ABC123456789de  
**License number** ABC123  
**Insurance number** 123456789  
**Owner** Sven Svensson

**Set the tolerance** 3 mm

**Notes**  
Some errors on the left front bumper

**PDF Report!**

**Example of a non-symmetric car**

report.pdf - Adobe Acrobat Pro

File Edit View Window Help

Create

1 / 1 71,4%

Tools Comment Share

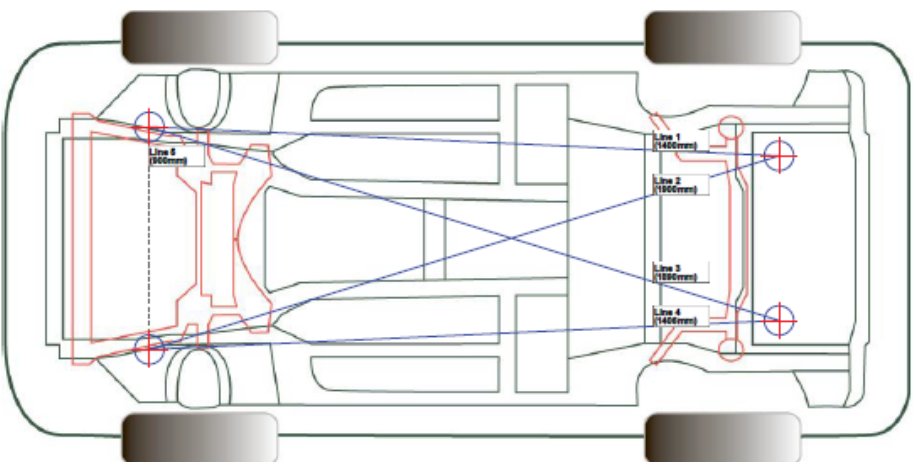
	Measured values	Spec. values	
Line 1	1400	1400	✓
Line 2	1900	1900	✓
Line 3	1890	1890	✓
Line 4	1406	1406	✓
Line 5	900	900	✓

<b>Manufacturer</b>	BMW
<b>Model</b>	320
<b>Year</b>	1998
<b>VIN</b>	ABC123456789de
<b>License number</b>	ABC123
<b>Insurance number</b>	123456789
<b>Owner</b>	Sven Svensson
<b>Set the tolerance</b>	3 mm

Notes
Some errors on the left front bumper

Example of a report on a non-symmetric car